

Ashbury East

19 Lot Private Community In Pleasant Prairie

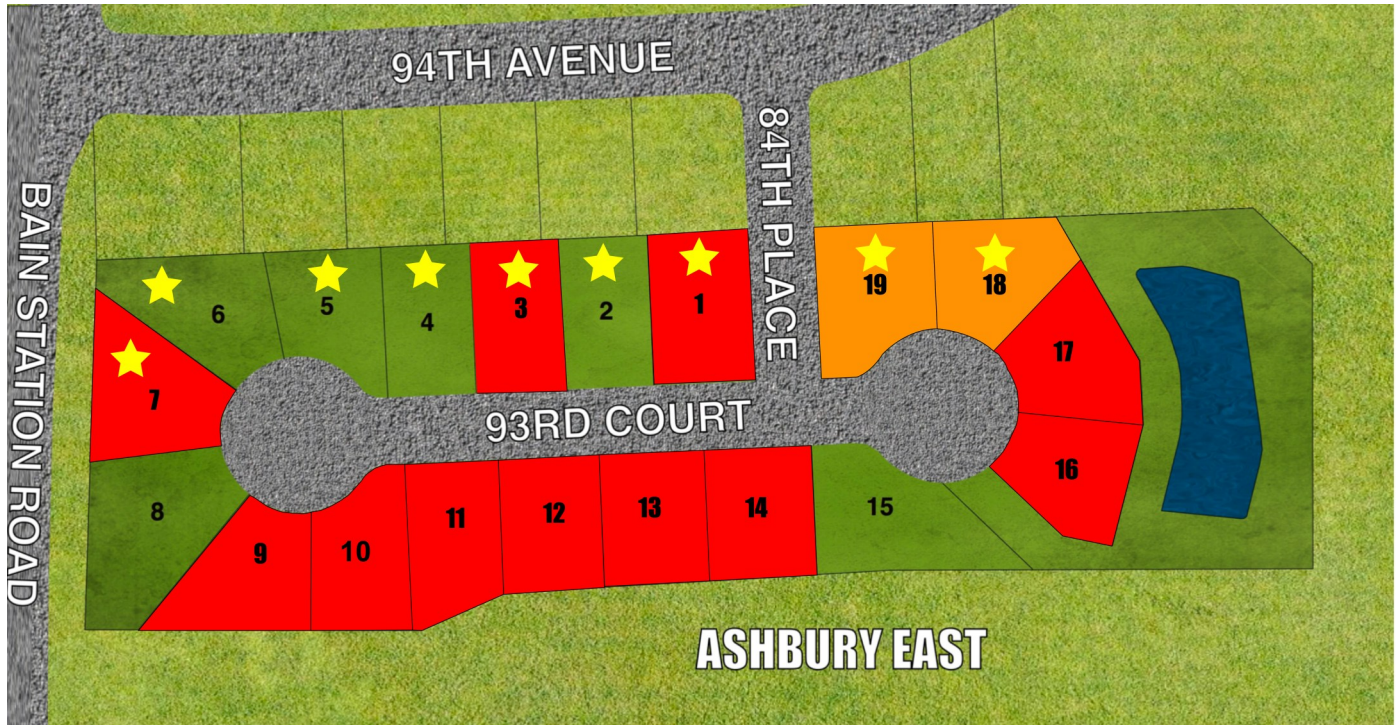

WALK OUT LOTS

AVAILABLE LOTS

RESERVED LOTS

- ◆ Lot 1 SOLD
- ◆ Lot 2 \$123,900 13,219 SF
- ◆ Lot 3 Canton {SOLD}
- ◆ Lot 4 \$124,900 14,068 SF
- ◆ Lot 5 \$125,900 13,220 SF
- ◆ Lot 6 \$135,900 15,813 SF
- ◆ Lot 7 SOLD
- ◆ Lot 8 \$139,900 20,070 SF
- ◆ Lot 9 SOLD
- ◆ Lot 10 SOLD
- ◆ Lot 11 SOLD
- ◆ Lot 12 SOLD
- ◆ Lot 13 SOLD
- ◆ Lot 14 SOLD
- ◆ Lot 15 \$125,900 17,859 SF
- ◆ Lot 16 SOLD
- ◆ Lot 17 SOLD
- ◆ Lot 18 \$138,900 13,507 SF
- ◆ Lot 19 \$129,900 15,370 SF



8501 75th St Suite H

Kenosha WI 53142

Office: 262-694-1677

www.HarpeDevelopment.com



focus on energy®

Partnering with Wisconsin utilities